



ख्वाजा मुईनुद्दीन चिश्ती भाषा विश्वविद्यालय, लखनऊ, उत्तर प्रदेश (भारत)
Khwaja Moinuddin Chishti Language University, Lucknow, U.P. (India)

U.P. STATE GOVERNMENT UNIVERSITY.
(Recognised Under Section 2(f) & 12(B) of the UGC Act, 1956 & B.Tech. Approved by (AICTE))

Underground tanks for the storage of Rain water





ख्वाजा मुईनुद्दीन चिश्ती भाषा विश्वविद्यालय, लखनऊ, उत्तर प्रदेश (भारत)

Khwaja Moinuddin Chishti Language University, Lucknow, U.P. (India)

U.P. STATE GOVERNMENT UNIVERSITY.

(Recognised Under Section 2(f) & 12(B) of the UGC Act, 1956 & B.Tech. Approved by (AICTE)

Underground and Overhead Reservoirs

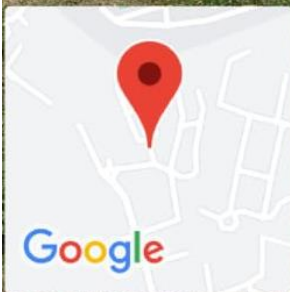

Lucknow, Uttar Pradesh, India

WVJW+G7M, Prabandh Nagar, Mubarakpur,

Lucknow, Uttar Pradesh 226201, India

Lat 26.931516°

Long 80.895151°

12/07/22 11:23 AM

Figure: Overhead Reservoir for storage and distribution of water



ख्वाजा मुईनुद्दीन चिश्ती भाषा विश्वविद्यालय, लखनऊ, उत्तर प्रदेश (भारत)
Khwaja Moinuddin Chishti Language University, Lucknow, U.P. (India)

U.P. STATE GOVERNMENT UNIVERSITY.

(Recognised Under Section 2(f) & 12(B) of the UGC Act, 1956 & B.Tech. Approved by (AICTE)



Figure: Underground tanks for water storage for emergency and fire fighting



Drawing and Details of Sewage Treatment Plant

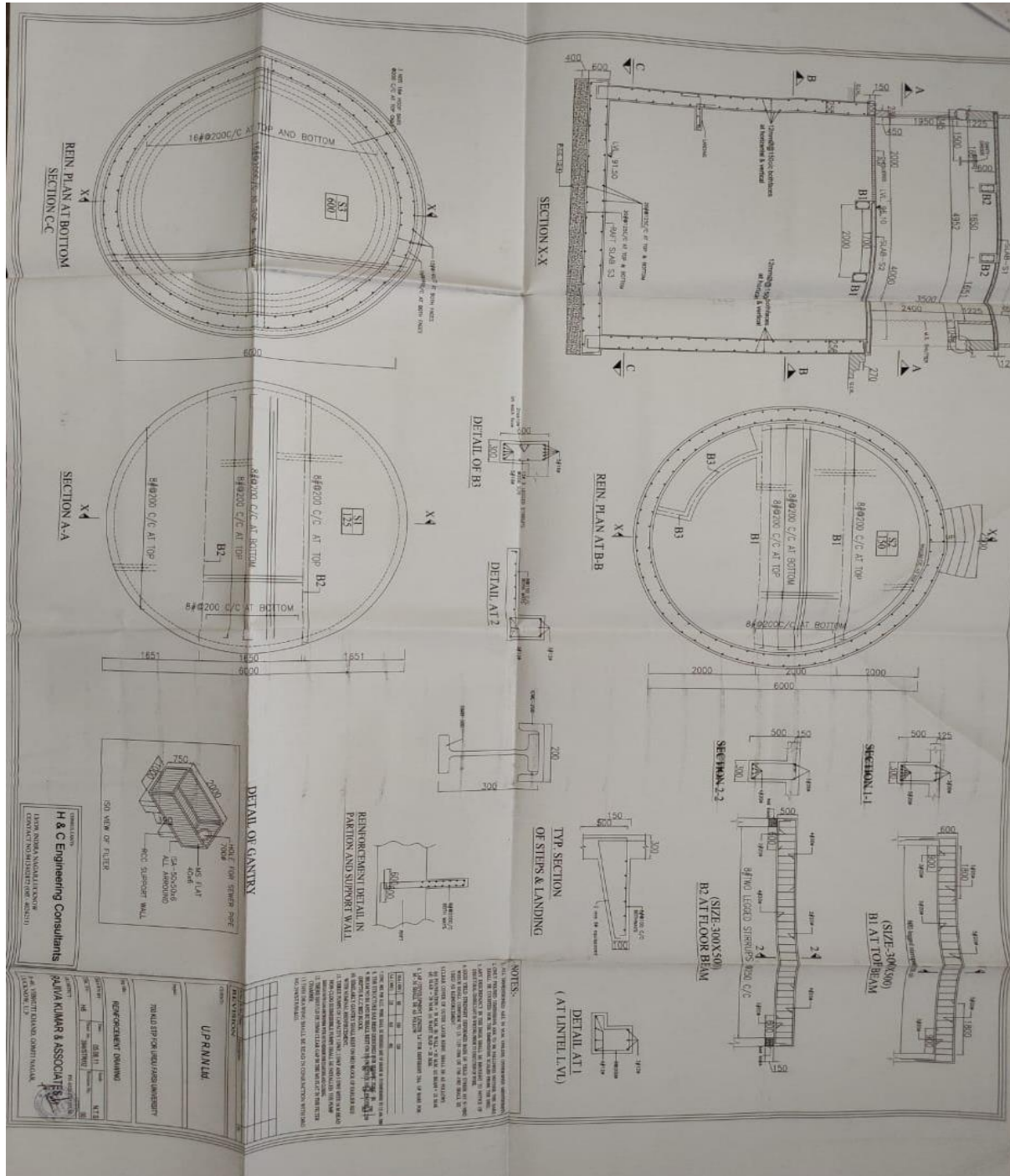



ख्वाजा मुईनुद्दीन चिश्ती भाषा विश्वविद्यालय, लखनऊ, उत्तर प्रदेश (भारत) Khwaja Moinuddin Chishti Language University, Lucknow, U.P. (India)

U.P. STATE GOVERNMENT UNIVERSITY,
(Recognised Under Section 2(f) & 12(B) of the UGC Act, 1956 & B.Tech. Approved by (AICTE))

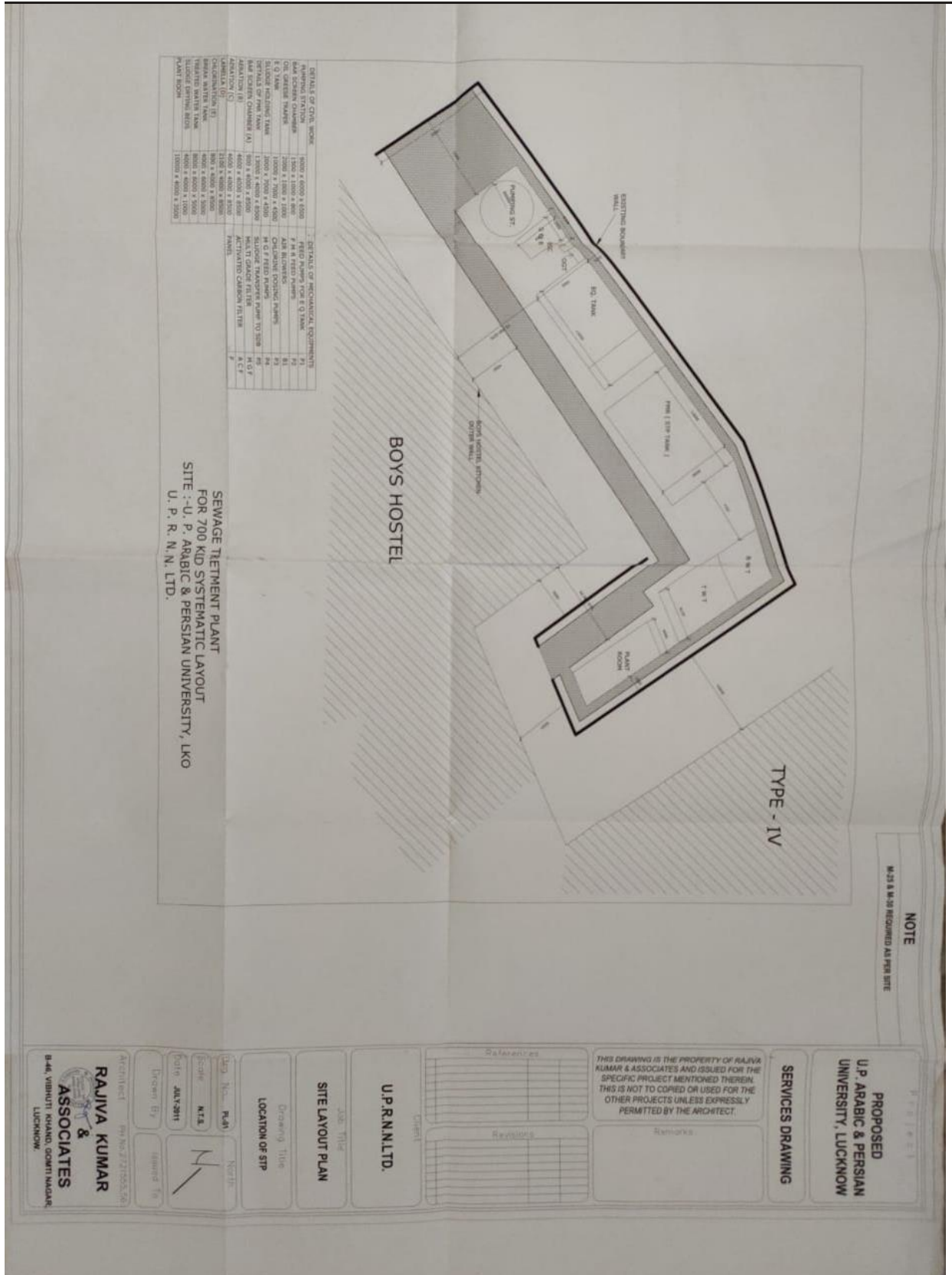

| DETAILS OF CIVIL WORK | | DETAILS OF MECHANICAL REQUIREMENTS | |
|---------------------------|---------------------|------------------------------------|-----|
| RAISING STATION | 4000 x 6000 x 6500 | FEED PUMP FOR R.O. TANK | 1 # |
| RAW WATER CHAMBER | 1500 x 1500 x 800 | FEED PUMP FOR R.O. TANK | 1 # |
| R.O. TANK | 2000 x 1500 x 1500 | A.M. CONTROL | 1 # |
| STORAGE HOLDING TANK | 4000 x 2000 x 4000 | FEED PUMP FOR R.O. TANK | 1 # |
| STORAGE FOR RAW WATER | 2000 x 4000 x 4000 | H.G. FEED PUMP | 1 # |
| STORAGE FOR TREATED WATER | 4000 x 4000 x 4000 | SOLUBLE TRANSPARENT PAINT TO 2000 | 1 # |
| ADAPTATION (A) | 4000 x 4000 x 2000 | PAINT FOR EXTERIOR SURFACE | 1 # |
| ADAPTATION (B) | 4000 x 4000 x 2000 | MULTI CONTACT FILTER | 1 # |
| ADAPTATION (C) | 22500 x 4000 x 8000 | STANDARD SCREENS 15 FT DIA | 1 # |
| ADAPTATION (D) | 4000 x 4000 x 2000 | PAINT | 1 # |
| ADAPTATION (E) | 4000 x 4000 x 2000 | | |
| ADAPTATION (F) | 4000 x 4000 x 2000 | | |
| ADAPTATION (G) | 4000 x 4000 x 2000 | | |
| ADAPTATION (H) | 4000 x 4000 x 2000 | | |
| ADAPTATION (I) | 4000 x 4000 x 2000 | | |
| ADAPTATION (J) | 4000 x 4000 x 2000 | | |

SEWAGE TREATMENT PLANT
FOR 700 KLD SYSTEMATIC LAYOUT
SITE :- U. P. ARABIC & PERSIAN UNIVERSITY, LKO
U. P. R. N. N. LTD.

PROPOSED U.P. ARABIC & PERSIAN UNIVERSITY, LUCKNOW

SERVICES DRAWING

THIS DRAWING IS THE PROPERTY OF RAJIVA KUMAR & ASSOCIATES AND ISSUED FOR THE SPECIFIC PROJECT MENTIONED THEREIN. THIS IS NOT TO BE COPIED OR USED FOR OTHER PROJECTS UNLESS EXPRESSLY PERMITTED BY THE ARCHITECT.

U.P. R. N. N. LTD.

SITE LAYOUT PLAN

Location of STP

Scale: N.T.S.

Date: 24/1/2011

Drawn By: [Signature]

Checked By: [Signature]

Architect: RAJIVA KUMAR & ASSOCIATES

B-46, VIBHUTI KHAND, GOVT NAGAR, LUCKNOW.



ख्वाजा मुईनुद्दीन चिश्ती भाषा विश्वविद्यालय, लखनऊ, उत्तर प्रदेश (भारत)
Khwaja Moinuddin Chishti Language University, Lucknow, U.P. (India)

U.P. STATE GOVERNMENT UNIVERSITY.

(Recognised Under Section 2(f) & 12(B) of the UGC Act, 1956 & B.Tech. Approved by (AICTE)

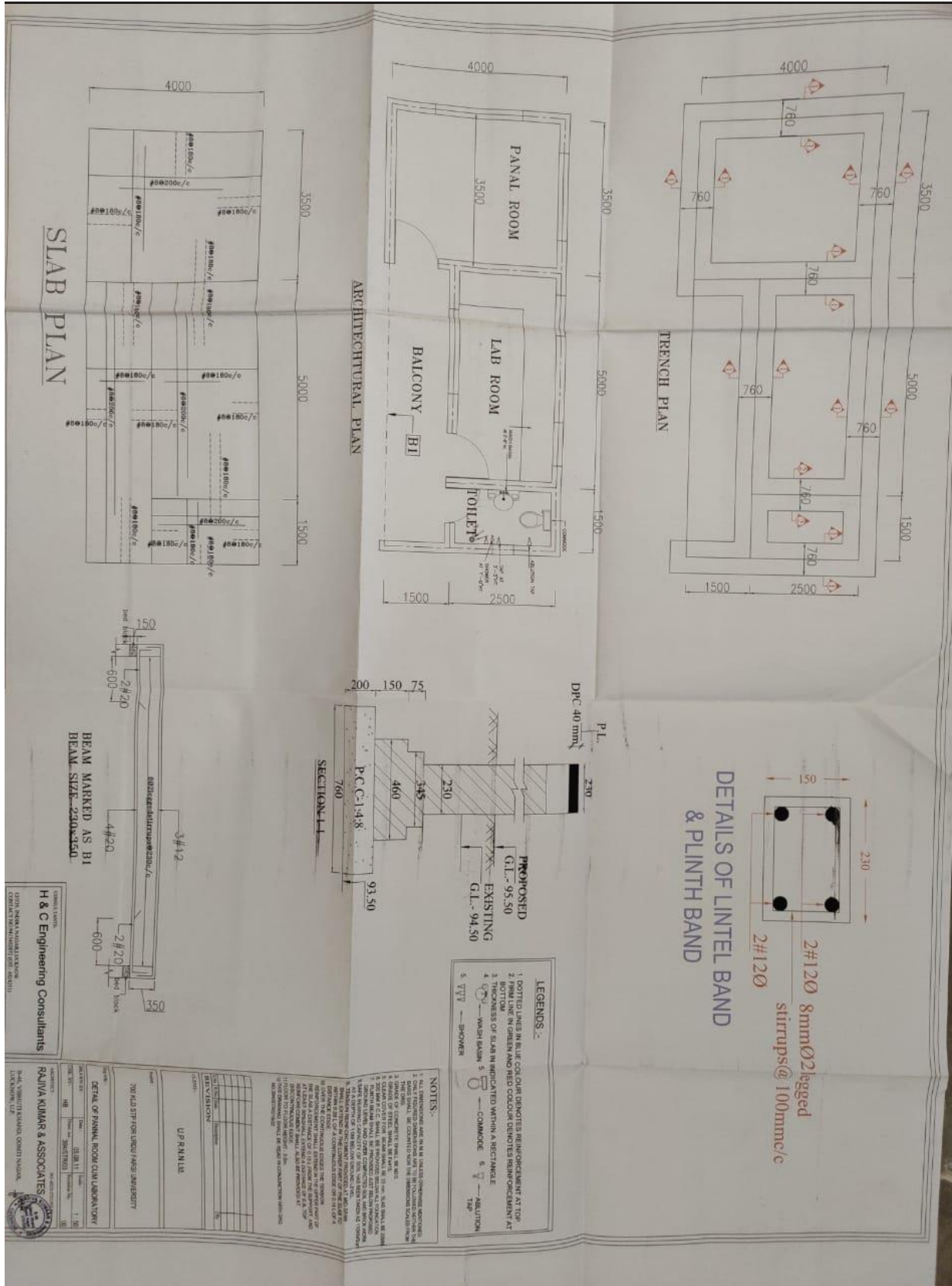



ख्वाजा मुईनुद्दीन चिश्ती भाषा विश्वविद्यालय, लखनऊ, उत्तर प्रदेश (भारत) Khwaja Moinuddin Chishti Language University, Lucknow, U.P. (India)

U.P. STATE GOVERNMENT UNIVERSITY,
(Recognised Under Section 2(f) & 12(B) of the UGC Act, 1956 & B.Tech. Approved by (AICTE))

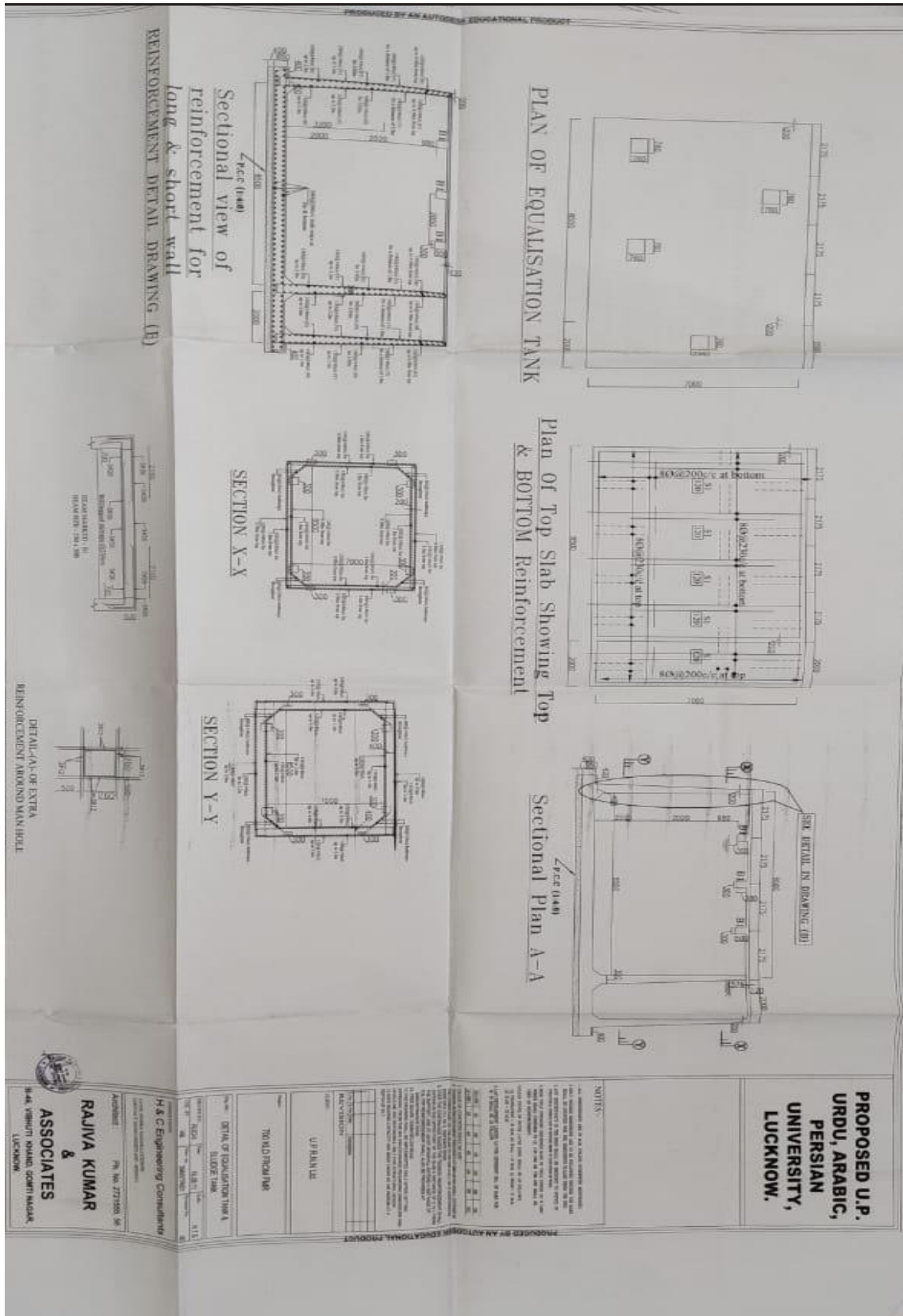

**PROPOSED U.P.
URDU, ARABIC,
PERSIAN
UNIVERSITY,
LUCKNOW.**

NOTES:

1. ALL DIMENSIONS ARE IN METERS UNLESS OTHERWISE SPECIFIED.
2. ALL WALLS ARE TO BE CONCRETE WITH 15% CEMENT SAND MORTAR.
3. ALL FLOORS ARE TO BE CONCRETE WITH 15% CEMENT SAND MORTAR.
4. ALL ROOFS ARE TO BE CONCRETE WITH 15% CEMENT SAND MORTAR.
5. ALL DOORS ARE TO BE 2.1M X 2.1M.
6. ALL WINDOWS ARE TO BE 1.5M X 1.5M.
7. ALL REINFORCEMENT IS TO BE IN ACCORDANCE WITH IS:456-1978.
8. ALL REINFORCEMENT IS TO BE IN ACCORDANCE WITH IS:1786-1970.
9. ALL REINFORCEMENT IS TO BE IN ACCORDANCE WITH IS:1786-1970.
10. ALL REINFORCEMENT IS TO BE IN ACCORDANCE WITH IS:1786-1970.

H & C Engineering Consultants
RAJIVA KUMAR & ASSOCIATES
34-A, YAMHATI ROAD, DOORAN MANSION, LUCKNOW

TO THE ENGINEER
DETAIL OF EQUALISATION TANK A
SCALE: 1/10

DATE: 10/10/2020
BY: RAJIVA KUMAR
CHECKED BY: RAJIVA KUMAR
SCALE: 1/10