



ख़्वाजा मुईनुद्दीन चिश्ती भाषा विश्वविद्यालय, लखनऊ, उत्तर प्रदेश (भारत)
Khwaja Moinuddin Chishti Language University, Lucknow, U.P. (India)

U.P. STATE GOVERNMENT UNIVERSITY

(Recognized Under Section 2(D) & 12(B) of the U.G.C. Act 1956 & B.Tech. Approved by AICTE)

HOSTEL MANUEL

KHWAJA MOINUDDIN CHISHTI LANGUAGE UNIVERSITY, LUCKNOW, U.P., INDIA.
(U.P. STATE GOVERNMENT UNIVERSITY)

(Recognized U/S 2(D) & 12(B) of the U.G.C. Act 1956 & B.Tech. approved by AICTE)



[Handwritten signature]

[Handwritten signature]

[Handwritten signature]

[Handwritten signature]

[Handwritten signature]

TITLE	Page No.
1. ADMISSION	3
2. ELIGIBILITY	3
3. ADMISSION CRITERIA	3
4. ADMISSION PROCEDURE	4
5. RENEWAL OF HOSTEL ADMISSION	4
6. DISQUALIFICATION	4
7. ATTENDANCE AND LEAVE RULES	5
8. VACATING SEAT/ROOM	5
9. MESS RULES	5
10. CONDUCT	6
11. DISCIPLINE	7
12. DISCIPLINARY ACTION	7
13. RAGGING	8
14. PUNISHMENT	8
15. VISITORS	9
16. GUESTS	9
17. HOSTEL WELFARE ASSOCIATION	9
18. GYMNASIUM	10
19. FEE PAYMENT SCHEDULE	10
20. MODE OF PAYMENT AND CANCELLATION	10
21. HOSTEL FEE STRUCTURE	11
22. LIST OF FUNCTIONARIES	13









ख्वाजा मुईनुद्दीन चिश्ती भाषा विश्वविद्यालय, लखनऊ, उत्तर प्रदेश (भारत)
Khwaja Moinuddin Chishti Language University, Lucknow, U.P. (India)
U.P. STATE GOVERNMENT UNIVERSITY
(Recognised Under Section 2(f) & 12(B) of the U.G.A. Act 1956 & B.Tech. Approved by UGC 11)

1. ADMISSION

- Students seeking admission in the hostel must apply on the prescribed application form available on university website/Warden's Office or from the office of Controller of Examination.
- Foreign students are required to submit the application for hostel accommodation through the Foreign Students Advisor duly forwarded by the respective Embassy.
- Admission to the hostels is exclusively on the basis of merit as per specified in admission criteria.
- The students who have availed hostel accommodation for one Programme and join another Programme will have to apply afresh on the prescribed application form for hostel accommodation & such cases will be treated as new admission.
- All foreign/ NRI students are required to give name, address, contact number of a person at Lucknow to be contacted in emergency.
- All applicants must provide a medical certificate clearly stating the history of any chronic disease. Hiding such medical condition shall lead to cancellation of hostel allotment.

2. ELIGIBILITY

- Accommodation in the University Hostels is available only to the bona-fide students of full-time courses.
- Applicant must have secured a minimum of 55% marks in aggregate in the last qualifying examination.
- Students against whom any disciplinary action has been taken by any University authority shall not be eligible for hostel accommodation.
- Students who accept employment or join any course outside Khwaja Moinuddin Chishti Language University in the Programme of their study will lose their entitlement to Hostel accommodation.

3. ADMISSION CRITERIA

S. N.	Criteria	Percentage/Po ints	Points	Ma x. Poi nts
1	Marks*	Marks obtained in the qualifying examination	60 60-70 70-80 >80	3 6 9 12
2	Economic Status**	Up to Rs. 3,00,000	10	10
		Rs. 3,00,000 – Rs. 6, 00, 000	6	
		Rs. 6, 00,000 and above.....	3	
2	Distance	Distance of University from hometown (after providing valid address proof)	<10Km 10-50 50-100 >100Km	3 6 9 12
3	Sports***	Level of Sports		9
		District Level		
		State Level		
		National Level		
4	NCC***	"A" Certificate		3



ख्वाजा मुईनुद्दीन चिश्ती भाषा विश्वविद्यालय, लखनऊ, उत्तर प्रदेश (भारत)
Khwaja Moinuddin Chishti Language University, Lucknow, U.P. (India)
U.P. STATE GOVERNMENT UNIVERSITY
(Recognised Under Section 20(i) & 12(B)(1) of the U.G.C. Act, 1956 & U.Tech. Approved by U.T.E.T.)

		"B" certificate	6	
	NSS/RR***	"C" certificate	9	
		240 Hrs / Nipun Certificate	5	
5	Interview	As per the assessment of interview committee constituted by Dean students welfare and Provost	8	8
Total Marks				60

- * For first Year Applicants of all program, the marks obtained in qualifying examination shall be considered.
** Income Certificate is required.
*** Supporting documents are required.

4. ADMISSION PROCEDURE

- The merit list of the students of each Program/Department shall be prepared separately.
- Available seats in the Hostels are distributed to each Program/Department on pro rata basis.
- A Committee constituted by the Vice Chancellor will conduct interview of the applicants for admission/re-admission in the Hostels.
- Students/Persons staying in the Hostel shall not be accepted as local guardian.
- For Hostel allotment, State Govt. Reservation policy will be applied.

5. RENEWAL OF HOSTEL ADMISSION

- The residents including foreign students who are promoted to II, III or Final semester of their respective programs shall be required to submit renewal forms in each academic session in the office of the Warden.
- Ph.D. residents are required to submit progress report of the research work through the supervisor and Head of the Department on a prescribed Performa along with renewal application form at the beginning of each academic session. The total duration of stay of a Ph.D. student in the hostel shall not exceed 5 years or submission of the thesis, whichever is earlier.
- The bona-fide resident whose result is awaited must apply in time but finally allotment may be granted only after the clearance of the results subject to the availability of seats in the hostel.
- The renewal of hostel admission would only be granted to those:
 - Who have secured minimum 60% marks in aggregate in previous examination.
 - Have cleared all dues before appearing at the annual/semester examination.
 - The conduct report of the said resident from the respective warden is satisfactory.
 - There are no complaints of indiscipline and misbehavior with the hostel staff or fellow residents.
- The maximum stay in the hostel in continuation shall not be of more than five years.

6. DISQUALIFICATION

The following students shall not be eligible for admission/renewal in the hostel:

- Those who failed in the examination for which they were given admission to the hostel.



- (ii) Those who were detained from appearing in examination by the university authorities.
- (iii) Those who did not appear in the examination on their own violation.
- (iv) Disciplinary action(s) was/were taken against them by the university authorities.
- (v) They have violated hostel rules by laws or have been found guilty to breach of hostel discipline and/or have been reprimanded, fined, or punished in any way by the Proctor/Wardens.
- (vi) They are employed part time or full time.
- (vii) They have stayed in the hostel for five years continuously.

7. ATTENDANCE AND LEAVE RULES

- (i) All the residents should return inside the hostel premises latest by 10:30 p.m. for boys and 5:30 p.m. in winter/ 7:00 p.m. in summer for girls. Residents returning to the hostel after the specified time shall record their name in the hostel register kept with the security guard at the gate indicating reason(s) for their late coming. Those found not following this rule shall be liable for punitive action leading up to expulsion from the hostel.
- (ii) Residents may be permitted to go out with their local guardians on Saturday/Sunday or during University holidays, for which they must seek prior permission from the Wardens on prescribed Performa.
- (iii) Residents desiring to leave the station must obtain written permission in advance on prescribed Performa from the Warden before leaving the hostel. If he/she desires to stay out of the hostel for more than five days, it will be mandatory to get permission in this regard from the Head of the concerned department.
- (iv) Residents going for research work/field work or attending seminar/conference or participating in sports tournament as a member of University team /departmental educational tour must submit prior written permission along with relevant documents from the HoD/ Games & Sports teacher/NSS officer in the office of the Warden before leaving the hostel.
- (v) Strict disciplinary action shall be taken against those, who fail to abide by the Leave/Attendance rules.

8. VACATING SEAT/ROOM

It shall be mandatory for the students to vacate Hostel rooms for the summer vacation for general maintenance work of the hostel.

- (i) All hostels will be closed for three days after the completion of even end-semester examination every year. In case of 'Pandemics' Govt. Guidelines will be followed.
- (ii) All residents shall vacate the hostel at the end of each academic session or within three days of the end-semester examination, or on the submission of Ph.D. dissertation/thesis.
- (iii) In the event of their vacating the hostel during the session, prior information of at least fifteen days shall be given by the resident.
- (iv) Residents must hand over hostel belongings provided to them, before leaving the hostel.
- (v) During summer vacations, residents are required to vacate their rooms and get them sealed by the hostel staff.
- (vi) Ph.D. scholars are supposed to follow the university vacation schedule and vacate the hostel as soon as the university closes. However, in special cases on recommendations from their respective supervisors through proper channel, accommodation will be provided in the identified room/hostel.

9. MESS RULES



ख़्वाजा मुईनुद्दीन चिश्ती भाषा विश्वविद्यालय, लखनऊ, उत्तर प्रदेश (भारत)
Khwaja Moinuddin Chishti Language University, Lucknow, U.P. (India)

U.P. STATE UNIVERSITY SYSTEM
(Recognized by the U.P. Government of Education, Lucknow, U.P. (India))

- (i) Mess is compulsory for all the residents.
- (ii) It should be noted that both vegetarian and non-vegetarian food shall be served in the mess. Due care shall be taken in preparing and serving food; however, no special or separate arrangements of utensils or other facilities shall be made in the hostel dining hall. Due to COVID-19 pandemic only vegetarian food will be served.
- (iii) The residents are required to take meals in the Hostel Dining Hall. Dining Hall timings shall be fixed as notified from time to time. All residents shall adhere to these timings.
- (iv) Food shall not be taken out of the Dining Hall. Only sick residents may be allowed by the Provost / Warden / Care-Taker to have light meals in their rooms on the written advice of the authorized doctor.
- (v) The caretaker shall record the daily attendance of the residents in the mess register at the time of breakfast and dinner.
- (vi) Carrying of mess articles/plates to the rooms or common places is strictly prohibited. Any violation will lead to disciplinary action.
- (vii) Roommates are not allowed to take food on behalf of absentees.
- (viii) The hostel mess may not function during the winter and summer vacations. However, for those residents who are permitted to stay in the hostel during summer vacation, if the mess functions, the charges would be as per arrangements made.
- (ix) Exemption in 5 diet / days charge will be allowed to those students who have taken prior approval from Provost/warden also head of the respective department.
- (x) Those students who are on leave, mess fees will not be charged from those students who will not be in the hostel due to their research work/ field work/ internship training. Students have to pay 10% of mess fees per month as establishment charges for this period to the university.

10. CONDUCT

- (i) Any resident damaging the hostel property in any manner shall pay the full cost, including installation charges, if any. In addition, he would also be liable to a fine imposed by the Warden/Provost.
- (ii) At the end of each academic year, assessment of damages to common utilities will be made by the hostel authorities and a "General Fine" may be imposed on residents.
- (iii) The use of electrical gadgets, like Refrigerator, Heater/blower, Immersion Heater, and TV etc. is prohibited. Any forbidden gadget, found in a hostel room, shall be confiscated and a fine of Rs. 2000/- may be imposed on the owner for the first violation, and expulsion, thereafter.
- (iv) Electric Kettle may be allowed with the prior written permission of the Warden on payment of Rs. 150/- per month as electricity charges.
- (v) Electric Desert Coolers are allowed with prior permission of the Warden on a payment of Rs. 500/- per month as Electricity Charges.
- (vi) Cooking inside the hostel room is strictly forbidden. Violation in this regard shall lead to confiscation of the cooking gadgets and a fine of Rs.1000/- shall be imposed on the resident.
- (vii) Keeping of Gas Cylinders inside hostel rooms is strictly prohibited. Violation of this clause will lead to expulsion from hostel.
- (viii) Music systems and CD players, etc. may be used in rooms strictly with Head-phones, provided the roommates and neighbors do not object. Any violation shall lead to the confiscation of these gadgets.
- (ix) Residents are not allowed to make noise especially after 10:00 p.m. as it would disturb the privacy of other residents nearby.
- (x) Residents are not allowed to hand over the keys of their rooms to any person other than the caretakers /hostel authorities.



ख्वाजा मुईनुद्दीन चिश्ती भाषा विश्वविद्यालय, लखनऊ, उत्तर प्रदेश (भारत)
Khwaja Moinuddin Chishti Language University, Lucknow, U.P. (India)

U.P. STATE GOVERNMENT UNIVERSITY,
(Recognised Under Section 20(i) & 12(B) of the U.G. Act, 1956 & B.Tech. Approved by (AICTE))

- (xi) Residents shall maintain hygiene and keep their rooms/washrooms and hostel premises neat and clean. Hostel Rooms may be inspected/checked by hostel/university authorities at any time.
- (xii) Residents are expected to come to Dining Hall, Common Room, Visitors' Room, Reading Room and Office properly attired, failing which they shall be liable for disciplinary action.
- (xiii) Residents must strictly follow the timings of TV/Common/Reading Rooms as notified from time to time.
- (xiv) No items from places of common use shall be taken to rooms. A default in this regard may attract a fine of Rs. 500/- per item.
- (xv) Residents using Scooter/Motorbikes are required to register their vehicles with the Proctor Office and submit copy of the registration to the Office of the Warden.
- (xvi) Residents are required to park their vehicle properly at the authorized parking provided in the hostel. If any vehicle is found in the gallery of the hostel a fine of Rs. 1000/- shall be imposed on the owner. Safety of the Vehicles is the owner's responsibility. Parking of any outsider vehicle is strictly prohibited. Disciplinary action shall be taken against the defaulters.
- (xvii) Any misuse of internet and Wi-Fi facility shall lead to strict punitive action.
- (xviii) Any violation will lead to expulsion from the hostel.
- (xix) Any prayers / pooja / namaz in common places of hostel will not be allowed. Students can use their rooms for such activities.

11. DISCIPLINE

- (i) Silence hours have to be observed from 10 p.m. to 6 a.m.
- (ii) Residents desirous of consulting Warden about their day-to-day problems can do so at the time specified by their respective Wardens.
- (iii) Residents are required to bring their own bedding and other items of personal use.
- (iv) No resident on his own shall shift from the allotted room to another room. No furniture should be shifted from one room to another.
- (v) All residents shall be issued a Resident Identity Card from the Office of the Warden. Residents must keep this card with them at all times and must produce the same on demand by hostel authorities and security staff. In case of loss, a duplicate card may be issued on payment of Rs. 50/- in cash.
- (vi) No resident shall indulge in any activity in his room/hostel, which may cause disturbance or annoyance to his roommate/neighbors or to the hostel/university authorities. Appropriate disciplinary action shall be taken against such students.
- (vii) Consumption/Possession of alcoholic drinks, narcotic drugs is totally banned. Any violation will lead to expulsion from the hostel.
- (viii) Smoking in the hostel premises is prohibited.
- (ix) The electricity bills, if found to exceed the regular amount, shall be collected from all residents.
- (x) Residents shall not misbehave with or manhandle any resident or office staff on duty. Any such misdemeanor shall attract severe punishment including expulsion from the hostel.
- (xi) Lights and fans must be switched off while leaving the room. Water taps should be closed properly after use. Posters or stickers should not be pasted on the hostel/room walls. Parties, social or political gatherings in the hostel complex are not permitted.



12. DISCIPLINARY ACTION

- The Warden / Provost can take disciplinary actions against the resident who will be found indulged in any kind of the following indisciplinary acts such as suppression of information in the application for admission, act of indiscipline, violation of any of the duly prescribed rules, indulgence in indecent or violent behavior, or for any other reason deemed sufficient for taking a disciplinary action. Actions may include; issue warning, intimate the parents/guardian, Head of the Department/ supervisor, if any, impose fine minimum penalty of Rs. 1000/-, double-lock the room/cancel the allotment of room of a resident/expel or forcibly evict a resident at the risk and cost of the resident or take any other disciplinary action, including banning the entry to the hostel and recommending non-issuance or de-recognition of degrees, depending upon the gravity of the act of indiscipline committed by a resident.
- The Warden/Provost and the university authorities reserve the right to expel students in case their conduct is found to be of a grave nature or on a disciplinary ground. In that case the entire hostel fees including the caution money will be forfeited.
- Residents are required to abide by all rules and instructions given in the Hostel Guidelines and as notified on the Notice Board from time to time. They are not to plead ignorance of the same. They are to co-operate with the hostel staff and actively participate in the smooth running of the hostel.
- At the time of admission, every student shall be required to sign a declaration that he submits himself to the disciplinary jurisdiction of the Vice-Chancellor, the Warden and other authority of the University who may be vested with the authority to exercise discipline under Khwaja Moinuddin Chishti Language University Act/ Statutes.
- Students found staying in the hostel without paying the requisite fees or without obtaining proper permission from the competent authorities will be evicted from the hostel without any prior notice and the authorities will not be responsible for any loss/damage of items or inconvenience caused during the eviction process.

13. RAGGING

- Ragging in all its forms is totally banned in the premises of the Boys' Hostel. Any student found indulging in Ragging will be expelled immediately from the hostel.
- As per University Grants Commission Letter No. F1-16/2007 (CPP-II), dated April, 2009 related to UGC Regulation on curbing the menace of ragging in higher educational institutions, 2009, the students are advised to take note of the following:
- As per the orders of Hon'ble Supreme Court of India "Ragging" means "Any conduct whether by words spoken or written or by an act which has the effect of teasing, treating or handling with rudeness any other students, indulging in rowdy or undisciplined activities which causes or is likely to cause annoyance hardship or psychological harm or to raise fear or apprehension thereof in a fresher or a junior student or asking the students to do any act or perform something which such student will not in the ordinary course do and which has the effect of causing or generating a sense of shame or embarrassment so as to adversely affect the physique or psyche of a fresher or a junior student". Punishable offenses of Ragging are:
 - Teasing, wrongful restraint, intimidation, rough handling causing physical or psychological harm, asking the student to perform an act which she/he may not do in



ख्वाजा मुईनुद्दीन चिश्ती भाषा विश्वविद्यालय, लखनऊ, उत्तर प्रदेश (भारत)

Khwaja Moinuddin Chishti Language University, Lucknow, U.P. (India)

U.P. STATE GOVERNMENT UNIVERSITY

(Recognised Under Section 20(i) & 12(B) of the U.G. Act, 1956 & U. Tech. Approved by (AICTE))

- the ordinary course. Abetment to ragging
- ii. Criminal Conspiracy to rag.
- iii. Unlawful assembly and rioting while ragging
- iv. Public nuisance created during ragging
- v. Violation of decency and morals through ragging
- vi. Injury to body, causing hurt
- vii. Assault as well as sexual offences or unnatural offences
- viii. Extortion

Strict action shall be taken against those found guilty of ragging and/or abetting ragging.

Each resident shall have to sign an undertaking to the effect that he is aware of the law regarding prohibition of ragging as well as the punishments, and to the effect that he has not been expelled and/or debarred from admission by any institution and that he if found guilty of the offence of ragging and /or abetting ragging, is liable to be punished appropriately at the time of joining the hostel.

An undertaking shall also be signed by the parent/guardian of the applicant to the effect that he is also aware of the law in this regard and agrees to abide by the punishment meted out to his ward in case the latter is found guilty of the offence of ragging and /or abetting ragging.

14. Punishment

Depending upon the nature and gravity of the offence as established by the Anti-ragging Committee of the institution, the possible punishments for those found guilty of ragging shall be any one or any combination of the following:

- (i) Suspension/ Expulsion from the hostel
- (ii) Cancellation of admission
- (iii) Rustication from the institution
- (iv) Debarring from admission in the hostel in future.
- (v) Fine, decided by the disciplinary committee.

Collective punishment: When the persons committing or abetting the crime of ragging are not identified, the institution shall resort to collective punishment.

15. VISITORS

- (i) Visitors will be allowed in the hostel premises only between 6 a.m. to 9 a.m. and from 5 p.m. to 9 p.m.
- (ii) In any emergencies visitors can stay with resident for maximum three days with prefixed charges of Mess and Accommodation.
- (iii) Visitors must provide all the details in the register available at the hostel gate with the security guard.
- (iv) On demand, the visitors must declare their identity through Identity Card/Aadhar Card etc.
- (v) All visitors must leave the hostel premises by 10:00 p.m. A visit beyond the specified hours shall attract legal action. Visitor's vehicles are not allowed inside the Hostel Campus.
- (vi) Residents are not permitted to allow visitors of the opposite sex in the hostel at any time for whatever reason(s).
- (vii) Any resident violating this rule will be evicted from the hostel.

16. GUESTS

- (i) Residents' guests are not allowed to stay in the hostel. Parents/ Relatives of residents may be allowed to stay in the University Guest House with prior permission of Warden/Provost/Registrar. In such cases the residents have to pay the charges applicable for such facility.



ख्वाजा मुईनुद्दीन चिश्ती भाषा विश्वविद्यालय, लखनऊ, उत्तर प्रदेश (भारत)
Khwaja Moinuddin Chishti Language University, Lucknow, U.P. (India)

U.P. STATE GOVERNMENT UNIVERSITY.
(Recognised Under Section 20(i) & 12(B) of the U.G. Act, 1956 & R. Tech. Approved by UGC, U.P.)

- (ii) It is the responsibility of the residents to ensure that unauthorized guests are not present in their rooms.
- (iii) The residents having unauthorized guests in hostel rooms shall be liable to disciplinary action which includes expulsion from hostel.
- (iv) No resident shall keep or give shelter to any debarred/campus banned/rusticated students in his room. In case of violation, the hostel allotment of the referring residents shall be cancelled.
- (v) Notwithstanding any of the punishment mentioned above, the Wardens and the University authorities reserve the right to expel students in case their conduct is found to be of a grave nature.

17. HOSTEL WELFARE ASSOCIATION

Residents are provided ample space of freedom to ensure smooth functioning of the hostel, and to generate a lively atmosphere. For the purpose, a Hostel Welfare Association consisting of Food, Sports and Cultural Committee is nominated / elected democratically by the General Body comprising of residents in each hostel separately. The respective Warden of the hostel shall be the Advisor of the Association. All the activities of the Association shall be held with the prior approval of the Warden. In this regard Wardens/Hostel Welfare Association shall discuss the proposal(s) for consensus.

18. GYMNASIUM

- (i) Gymnasium facility is available to the resident members on a nominal fee of Rs. 1500/- per annum (or Rs. 500/- per quarter). Membership of the Gym shall be granted on merit to be determined by the duly constituted committee.
- (ii) The timing of Gymnasium facility shall be decided after due consultations with In- Charge of University gymnasium. The members shall strictly abide by the rules & regulations of the Gym, failing which disciplinary action will be taken against them. Gymnasium will remain closed during summer and winter vacations.

19. FEE PAYMENT SCHEDULE

(a) Mess Fee:

- (i) All students must pay the prescribed mess fee, which may be revised from time to time. Mess will generally function from July to the end of end-semester examination of odd semester, and from January to the end of end-semester examination of even semester every year.
- (ii) Every resident has to deposit a sum of Rs. 3000/- towards Mess Advance Fee at the time of admission. Mess Advance Fee will be adjusted at the time of last month of year. On prior information, the Warden (Mess) may allow the adjustment of mess remission at the end of session. However, no mess refund shall be allowed for less than 7 consecutive days and not more than 30 days in one academic year. No claim for remission of food charges shall be entertained if the resident has not submitted prior application to the concerned Warden/Caretaker.
- (iii) If the resident fails to deposit the Mess Fee on due date, the mess facility shall be withdrawn and an appropriate action shall be taken against such defaulters including expulsion from the hostel.

(b) Hostel Fee:

- (i) Hostel Fee may be submitted in TWO INSTALLMENTS at the time of hostel allotment to a fresh candidate, however, for students seeking renewal shall have to pay the full annual fee in advance.

20. MODE OF PAYMENT AND CANCELLATION



- Payment will be made in two installments only (Resident have to submit 5 Months mess fees in advance in each semester).
- If the resident fails to deposit the Hostel Fee on due date, a late payment fine of Rs. 200/- shall be charged for the first 5 days, after which their candidature for the allotment might stand cancelled. The candidate may, however, be re-admitted with the permission of the Warden on payment of re-admission charges of Rs.1000/- provided vacant room in the hostel is available.
- Hostel and Mess Caution Money will be refunded to the resident within one year from the date of leaving the hostel. However, residents are required to produce a clearance certificate from the concerned Office/Department/Centre before claiming the same on a prescribed form available in the registrar Office.
- The claim of the student for reimbursement of caution money shall stand forfeited or deemed to have been relinquished, if it is not claimed within one year from the date of leaving the hostel.
- In case of withdrawal of admission from the hostel within 15 days, all the fees except the admission fees shall be refunded.
- On withdrawal beyond 15 days, no fees will be refunded except the Caution Money on the production of the clearance certificate.

21. HOSTEL FEE STRUCTURE

Hostel fee for students admitted before 2022-2023 session:-

SL	Heads of Fee	New Allotment Single Occupancy (in Rs) Installment wise			Renewal Single Occupancy (in Rs) Installment wise			New Allotment Double Occupancy (in Rs) Installment wise			Renewal Double Occupancy (in Rs) Installment wise		
		First	Second	Total	First	Second	Total	First	Second	Total	First	Second	Total
1	Admission Fee	100	100	200	100	100	200	400	400	200	400	400	200
2	Maintenance Fee	413	412	825	413	412	825	413	412	825	413	412	825
3	Room Rent	3000	3000	6000	3000	3000	6000	2250	2250	4500	2250	2250	4500
4	Electricity water charges	500	500	1000	500	500	1000	500	500	1000	500	500	1000
5	Caution Money	1000	-	1000	-	-	-	4000	-	4000	-	-	-
Total		5013	4012	9025	4013	4012	8025	4263	3262	7525	3263	3262	6525



ख्वाजा मुईनुद्दीन चिश्ती भाषा विश्वविद्यालय, लखनऊ, उत्तर प्रदेश (भारत)
Khwaja Moinuddin Chishti Language University, Lucknow, U.P. (India)
(Recognised Under Section 2(f) & 12(B) of the U.G. Act, 1956 & U Tech. Approved by UGC, U.P.)

(21/11/2023-2)



ख्वाजा मुईनुद्दीन चिश्ती भाषा विश्वविद्यालय, लखनऊ, उत्तर प्रदेश (भारत)
Khwaja Moinuddin Chishti Language University, Lucknow, U.P. (India)

FEE STRUCTURE (YEAR WISE) 2022-23
HOSTEL FEE (REGULAR STUDENTS)

Sl. No.	HEAD	NEW ALLOTMENT (IN RS.)	RENEWAL (IN RS.)
1	ADMISSION FEE	1000	1000
2	MAINTENANCE FEE (ELECTRICITY & CIB)	1000	1000
3	COMMON ROOM CHARGES	1000	1000
4	KITCHEN MAINTENANCE (CROCKERY)	1000	1000
5	CULTURAL ACTIVITIES CHARGE INCLUDING MAGAZINES	2000	2000
6	SPORTS	150	150
7	ROOM RENT	8000	8000
8	ELECTRICITY WATER CHARGES	1500	1500
9	CAUTION MONEY	10000	0
	TOTAL	12650	11650

FEE STRUCTURE (YEAR WISE) 2022-23
HOSTEL FEE

Sl. No.	HEAD	New Allotment Single Occupancy for Ph.D. Scholars (in Rs.)	New Allotment Double Occupancy (in Rs.)
1	ADMISSION FEE	2000	1000
2	MAINTENANCE FEE	6500	4500
3	ROOM RENT	8000	4000
4	ELECTRICITY WATER CHARGES	4500	2500
5	CAUTION MONEY	2000	2000
	TOTAL	23000	14000

Note - ध्यान दें कि अतिरिक्त Caution Money और इन अन्य सफाई शुल्क काफ़ी हैं जिसे धरें।

४
वित्त अधिकारी
ख्वाजा मुईनुद्दीन चिश्ती
भाषा विश्वविद्यालय, लखनऊ

Forwarded to webmaster
to upload on website;
[Signature]

४
कुलपति
ख्वाजा मुईनुद्दीन चिश्ती
भाषा विश्वविद्यालय, लखनऊ

उक्त के अतिरिक्त विश्वविद्यालय पुरुष एवं महिला छात्रावास के समस्त छात्र / छात्रों को मेस के

[Signatures]



ख्वाजा मुईनुद्दीन चिश्ती भाषा विश्वविद्यालय, लखनऊ, उत्तर प्रदेश (भारत)
Khwaja Moinuddin Chishti Language University, Lucknow, U.P. (India)
U.P. STATE GOVERNMENT UNIVERSITY
(Recognized under Section 7(D) & 12(B) of the U.C. Act, 1956 & B Tech. Approved by UPEU)

मासिक भोजन के रूप में डे धनराशी प्रत्येक माह के प्रथम सप्ताह अर्थात् प्रत्येक माह की 05 तारीख तक जमा करनी होगी। साथ ही साथ उपरोक्तानुसार विश्वविद्यालय पुरुष एवं महिला छात्रावास के समस्त छात्र / छात्रों को मेस के प्रारंभ में मेस धनराशी ₹ 03,000/- (तीन हजार) अग्रिम के रूप में जमा करनी होगी, जो की अंतिम सेमेस्टर के अंतिम माह में समायोजित की जाएगी।

22. LIST OF FUNCTIONARIES

Provosts

Netaji Subhash Boys' Hostel Prof. Ehtesham Ahmad	Rani Luxmibai Girls Hostel Dr. Tatheer Fatima
---	--

Wardens

Netaji Subhash Boys' Hostel 1. Dr. Wasi Ahmad Azam Ansari 2. Dr. Udham Singh	Rani Luxmibai Girls Hostel 1. Priyanka Suryavanshi 2. Dr. Mamta Shukla
--	--

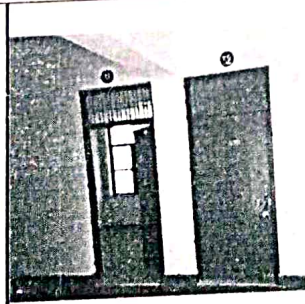
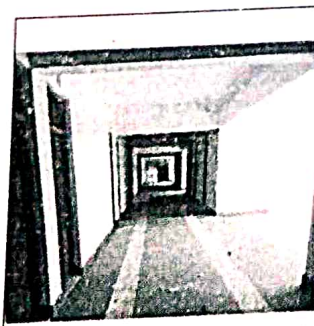

17/09/22
Dr. Udham Singh

Dr. Wasi Ahmad Azam
Ansari

Dr. Mamta Shukla

Dr. Neeraj Shukl

Dr. Tatheer Fatima
(Members Hostel Management Committee)

Prof. Ehtesham Ahmad