

# Facilities for the Management of Degradable and Non-degradable Wastes

## Solid Waste Cleaning



The routine cleaning and maintenance of open spaces within the University campus is done on daily basis



Regular Cleaning and maintenance of sports and playing areas  
of University

*Bmisha*  
REGISTRAR  
KHWAJA MOINUDDIN CHISHTI  
LANGUAGE UNIVERSITY,  
LUCKNOW



## Solid Waste Collection

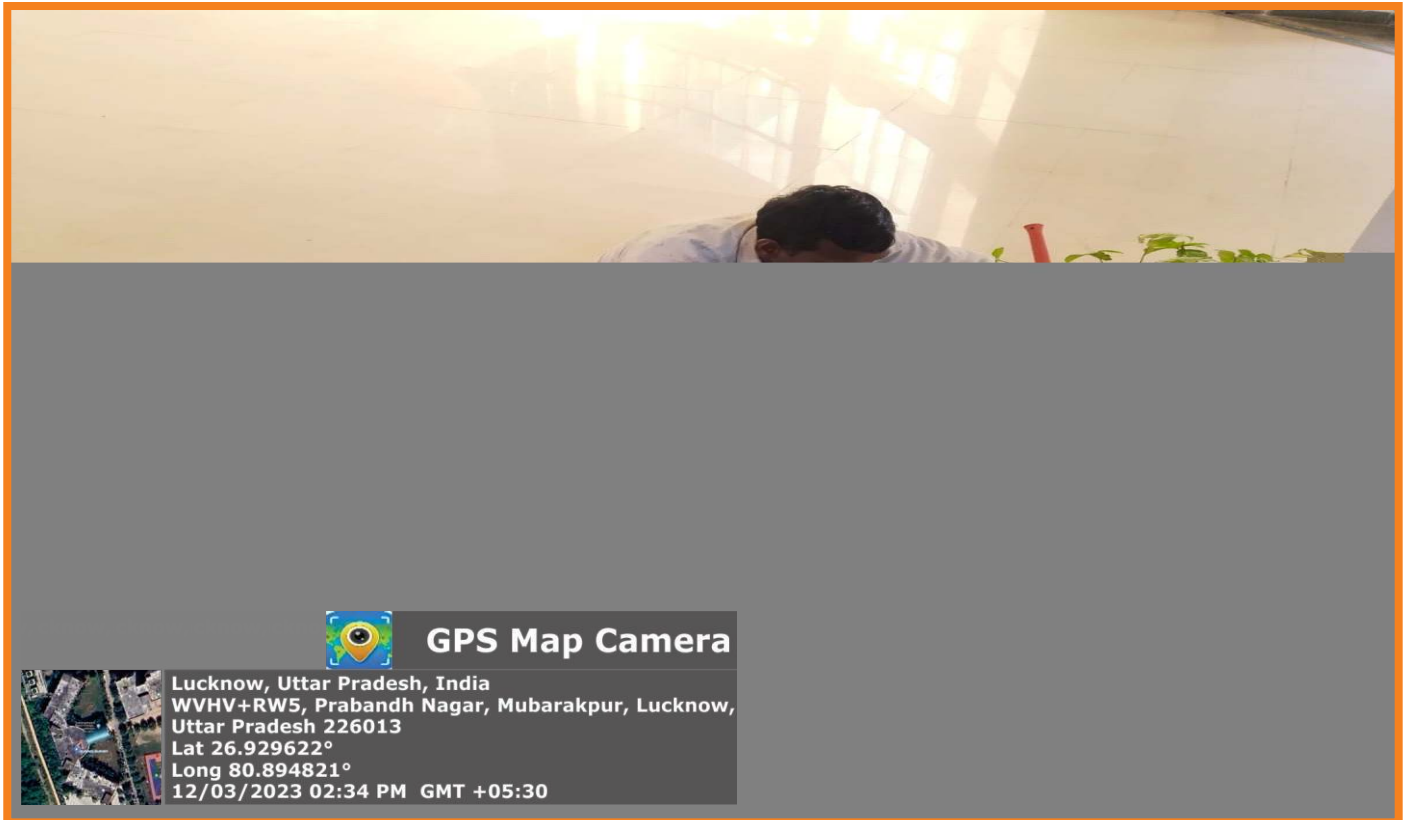

Regular cleaning of indoor areas within the University for maintaining hygiene standards



Waste collection by cleaning staff

*Bmisha*  
REGISTRAR  
KHWAJA MOINUDDIN CHISHTI  
LANGUAGE UNIVERSITY,  
LUCKNOW



## Solid Waste Segregation



Segregation of Garbage collected in bins into bio-degradable and non bio-degradable materials

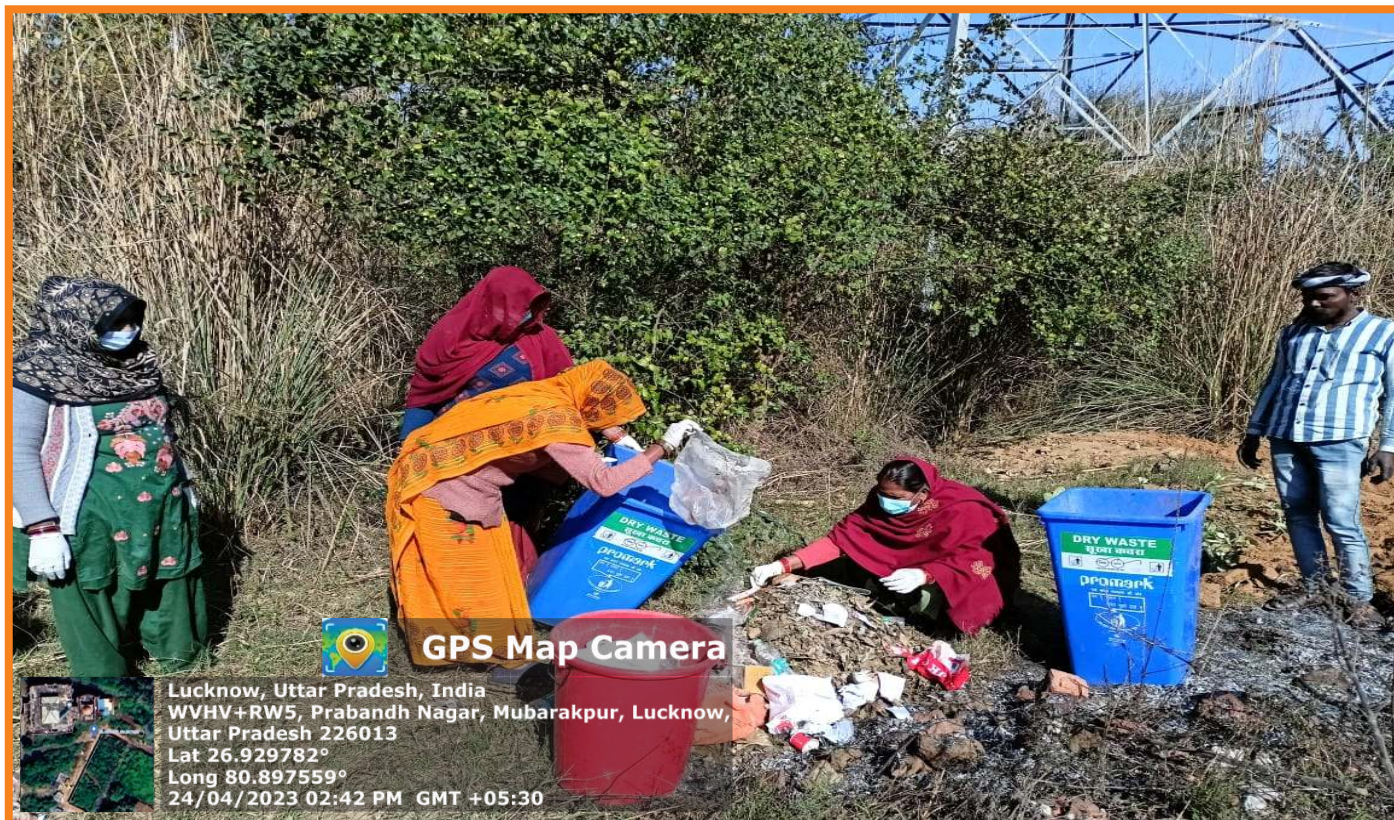

Solid waste is properly segregated for waste management



## Composting of Bio-Degradable Waste Material



Dumping of bio-degradable waste material into pits for composting

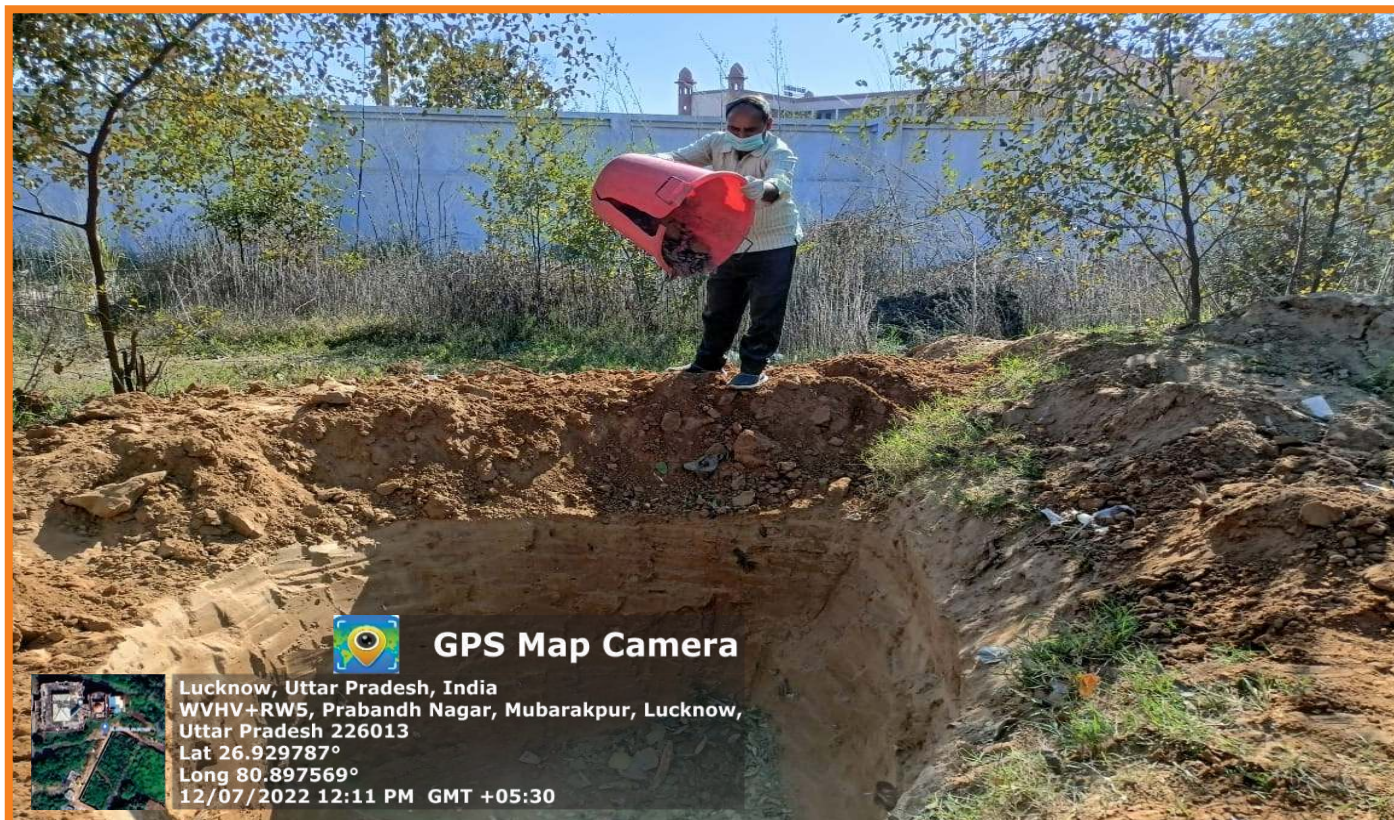

Bio-degradable waste material of the University is regularly dumped into pits for composting



## Garbage Disposal



Non- biodegradable waste materials are properly disposed of into garbage collection trucks from Municipal Corporation

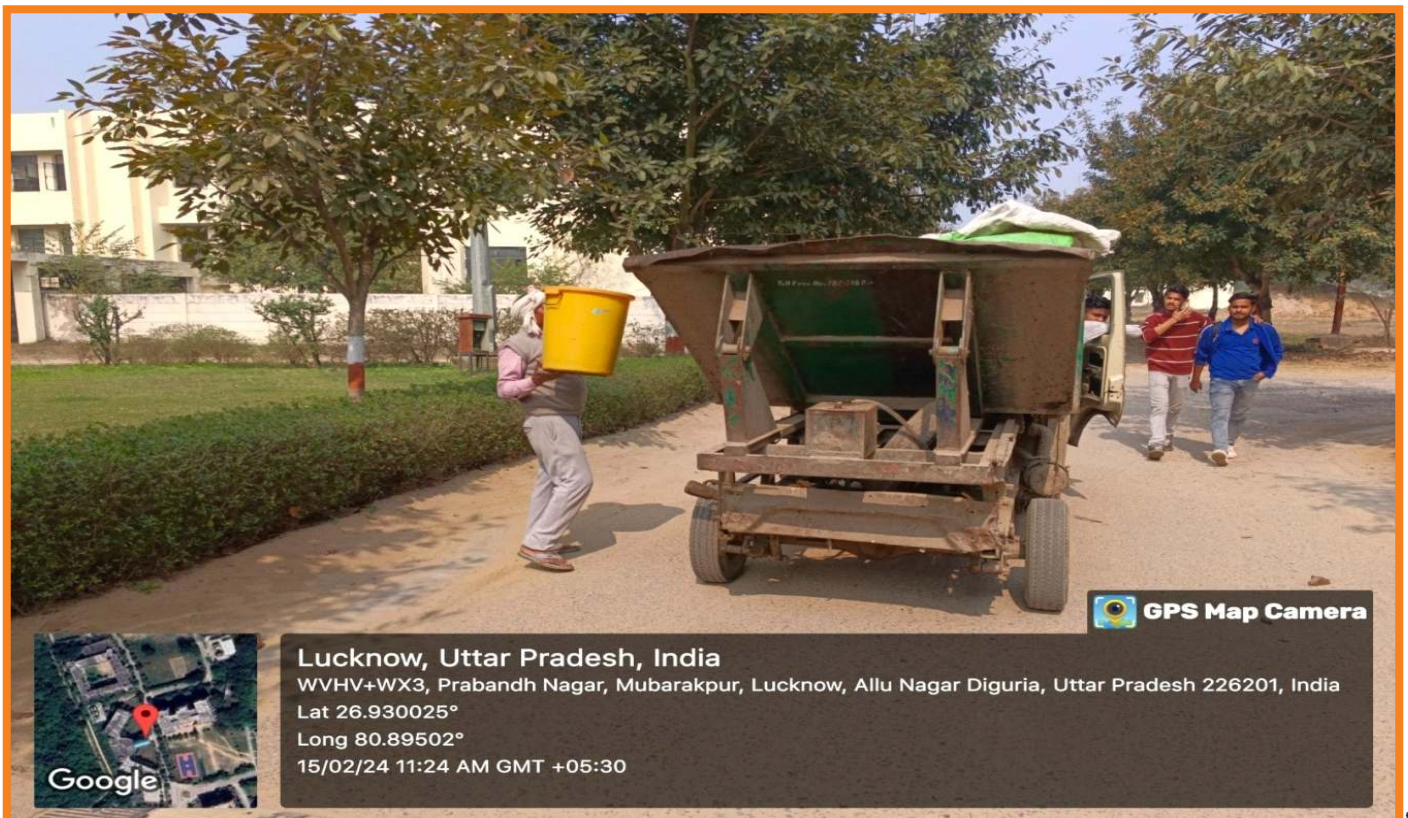

Garbage collection trucks from Municipal Corporation regularly come to the University for Waste Collection



## Waste Receptacles



Waste receptacles strategically positioned indoors and outdoors serve to facilitate proper disposal across various locations.



Waste receptacles strategically placed at various locations



## Waste Bins



Bins for garbage collection in the Girls Hostel



Bins for Composting the Biodegradable Waste in the Girls Hostel



# Liquid Waste Management

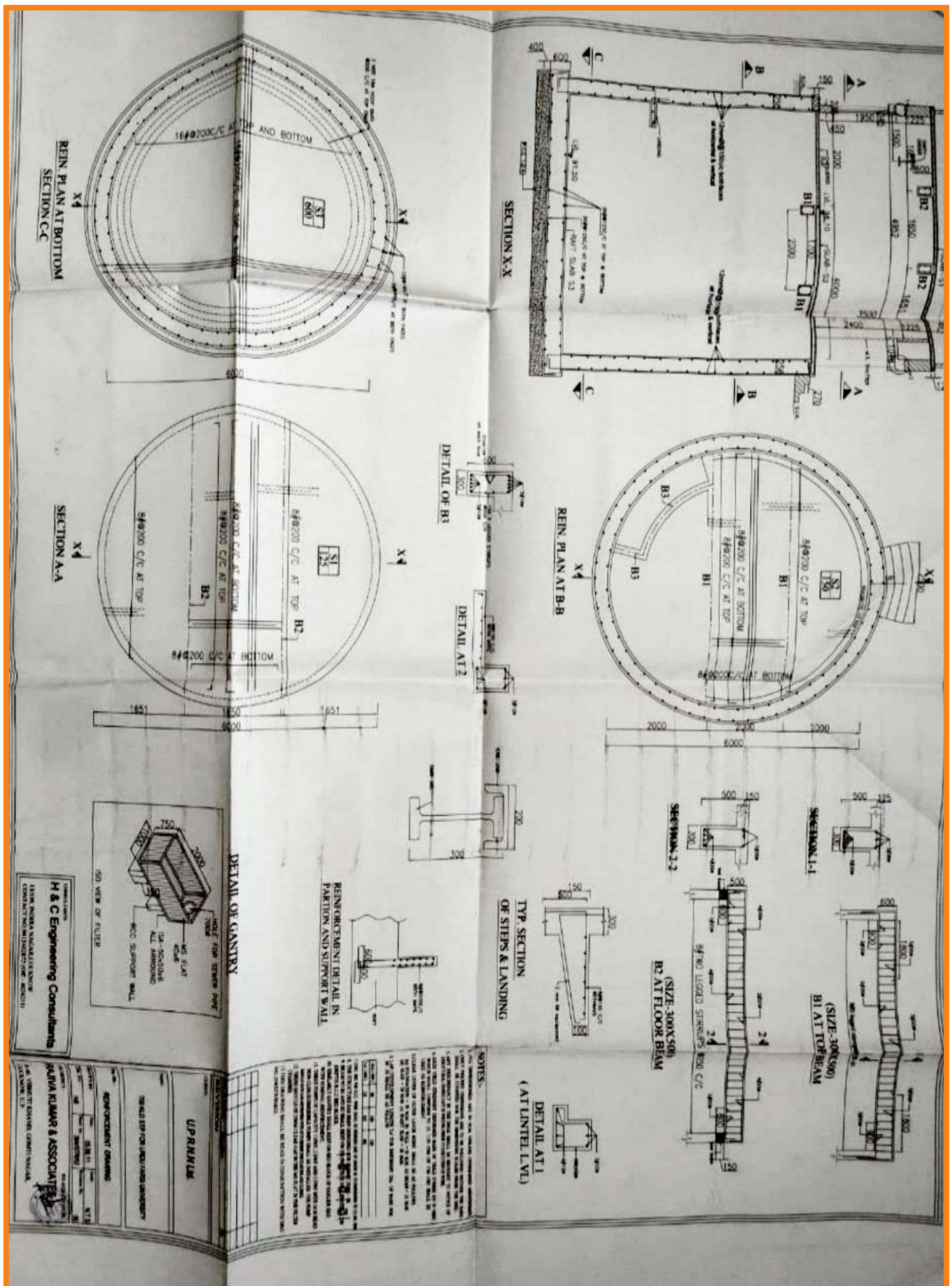

Illustration of sewage treatment plant of University

*Bmisha*

REGISTRAR  
KHWAJA MOINUDDIN CHISHTI  
LANGUAGE UNIVERSITY,  
LUCKNOW



# Liquid Waste Management

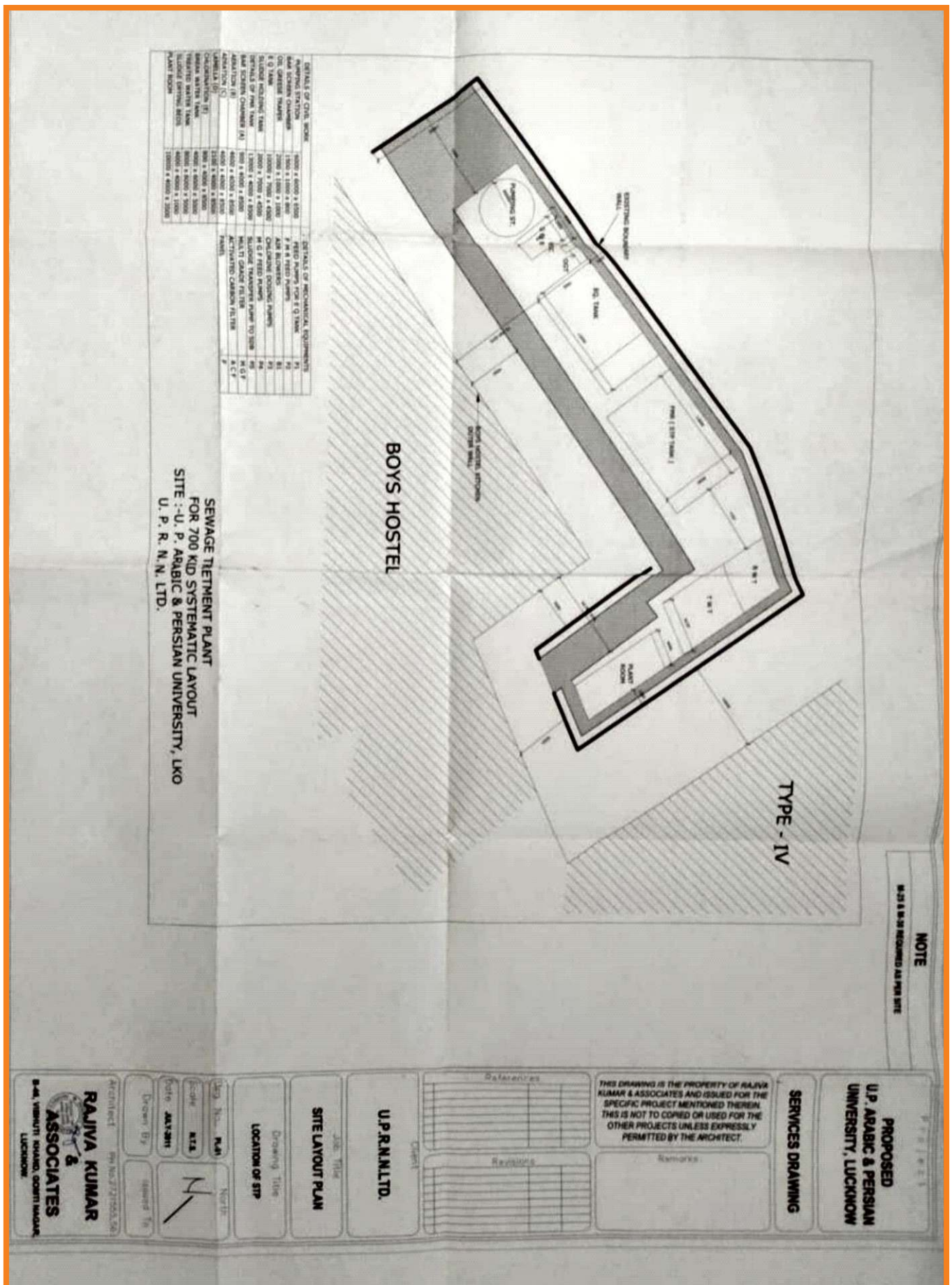

Description of the sewage treatment facility



## Liquid Waste Management

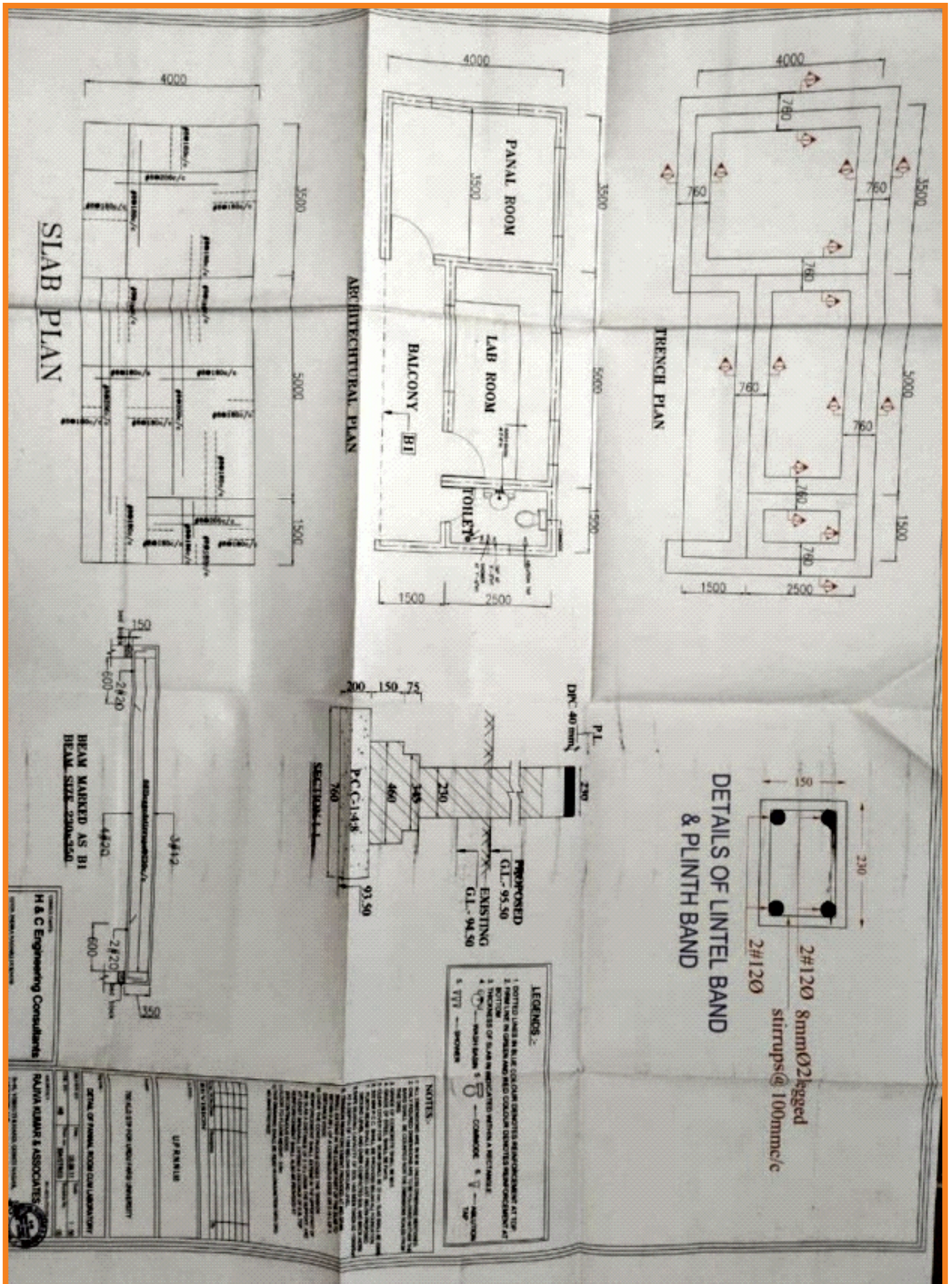

Detailed Illustration and specifications of the sewage treatment facility in University

REGISTRAR  
KHWAJA MOINUDDIN CHISHTI  
LANGUAGE UNIVERSITY,  
LUCKNOW





उत्तर प्रदेश राजकीय निर्माण निगम लिमिटेड  
Uttar Pradesh Rajkiya Nirman Nigam Ltd.  
(U.P. GOVT. UNDERTAKING)

पंजीकृत कार्यालय :  
विश्वेश्वरैया भवन, विभूति खण्ड,  
गोमती नगर, लखनऊ  
पोस्ट बाक्स : 11 फ़ैक्स : 0522-2720846  
पी.बी.एक्स. : 2720671, 2720665, 2720670

कार्यालय  
इकाई प्रभासी  
अरबी फारसी विश्वविद्यालय,  
इकाई-2, लखनऊ

इकाई कार्यालय :  
अरबी फारसी विश्वविद्यालय परिसर,  
सीतापुर हरदोई बाईपास  
(निकट आई.आई.एम.)  
पोस्ट-डिगुरिया, लखनऊ-226020  
e-mail : mskarbifarsi@yahoo.com

संदर्भ : इ0प्र0/अफाविड-2/रानिनि/इन्वेन्ट्री/2014

दिनांक : 23/03/2014

एस0टी0पी0 की इन्वेन्ट्री

अरबी फारसी विश्वविद्यालय परिसर में नवनिर्मित सीवर ट्रीटमेन्ट प्लान्ट का निर्माण कार्य पूर्ण है, कृपया हस्तगन लेने का कष्ट करें।

हस्तगनकर्ता  
उप अभियन्ता  
उ0 प्र0 राजकीय निर्माण निगम लि0  
अरबी फारसी विश्वविद्यालय इकाई  
लखनऊ

प्राप्तकर्ता

*Bmisha*

REGISTRAR  
KHWAJA MOINUDDIN CHISHTI  
LANGUAGE UNIVERSITY,  
LUCKNOW